

Dear God and Father of all,

Thank you for our parish family—for the love and sense of community we share. Thank you for the sacrifice of those who built this church. Thank you for the growth that challenges us to grow further.

As we begin this capital campaign for new worship space at Church of the Advent, soften our hearts and our wills to carry out your plan for this church in Lillian. Give us vision, energy, and courage as we prepare a legacy for generations to come. Help us to know our role in the spread of your Gospel. Remind us that we are temporary stewards of all your gifts.

Bless our efforts, to the glory of your Son, Jesus Christ. **AMEN**



Episcopal Church *of the Advent*

12099 County Road 99, Lillian, AL 36549 :: 251-961-2505 :: www.adventlillian.org

The Episcopal Church of the Advent provides opportunities for worship, fellowship, joy, spiritual growth, and community service, all for the love of God.

A **Bridge** *to a* **Dream**

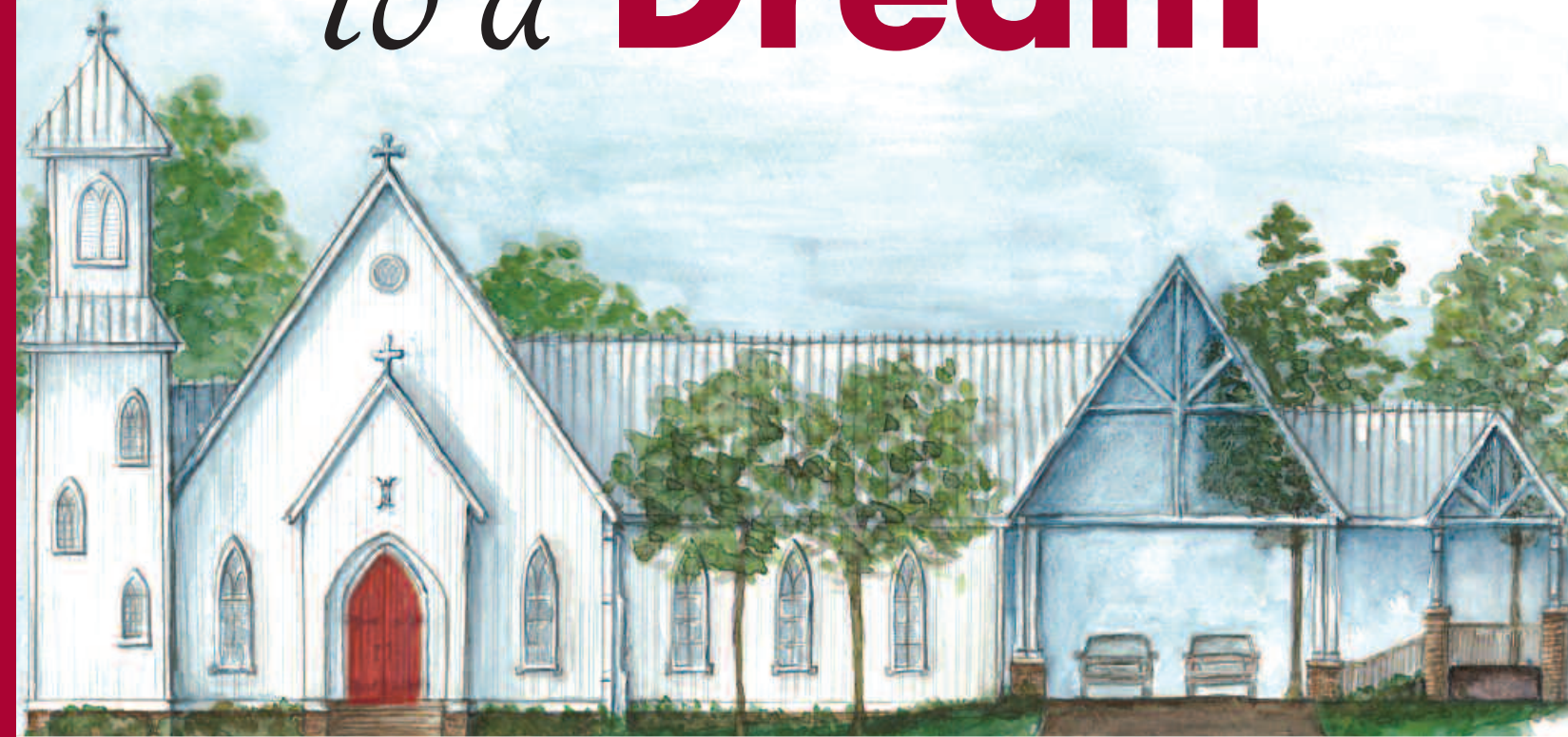

A capital campaign for Episcopal Church of the Advent.



After years of prayer and preparation, Church of the Advent is poised to build a permanent spiritual home. Please consider your part in this important moment in the life of our parish.

Welcome home

How you can help

First, give generously to our stewardship appeal to help power Church of the Advent's many ministries.

Second, consider a sacrificial pledge to the capital campaign—to build a lasting spiritual home for Church of the Advent.

To reach our capital campaign primary goal of \$300,000, gifts of every size are crucial. Please review the following gifts essential chart and consider your part in this important effort.

NEW CONSTRUCTION \$600,000

The currently proposed building design is an attractive, approximately 3,800 square-foot, Southern Gothic style, board-and-batten design. It will have a welcoming front porch and an ample narthex for meeting and greeting. With a seating capacity of about 120 plus choir seating, it will allow for significant future growth. Natural light would flood the space through hurricane glass windows tinted to reduce glare, and the altar would be flanked by a sacristy and flower guild rooms. The design includes dedicated sanctuary space for the choir, as well as choir vesting and storage areas. A cozy parlor for funerals and weddings is also part of the plan. Strong consideration has been given to energy efficiencies as an integral component of the design, with heavy foam insulation and efficient lighting. Site preparation expenses are included.

- Organ: \$50,000
"Rachel's Dream." Rachel Hovde, a founding member and classical organist, dreamed of excellent music. A portion of her bequest, \$25,000, was to be towards her vision for an organ. The cost of an organ will be offset by this bequest.

CHALLENGE ITEMS \$185,000

To be completed after the \$600,000 is accomplished:

- Porte Cochere to connect sanctuary and existing parish hall: \$35,000
- Bell Tower: \$75,000
- Memorial Gardens and Columbarium: \$25,000
- Landscaping: \$10,000
- "Dream Walk" canopy over deck and roof of parish hall: \$40,000

Total Primary Projects Cost: \$600,000

- Our Progress So Far (inc. Hovde bequest): \$300,000

Primary Campaign Needs: \$300,000

Primary Campaign + Challenge Goal: \$485,000

Although we may need a construction bridge loan, no mortgage is anticipated!

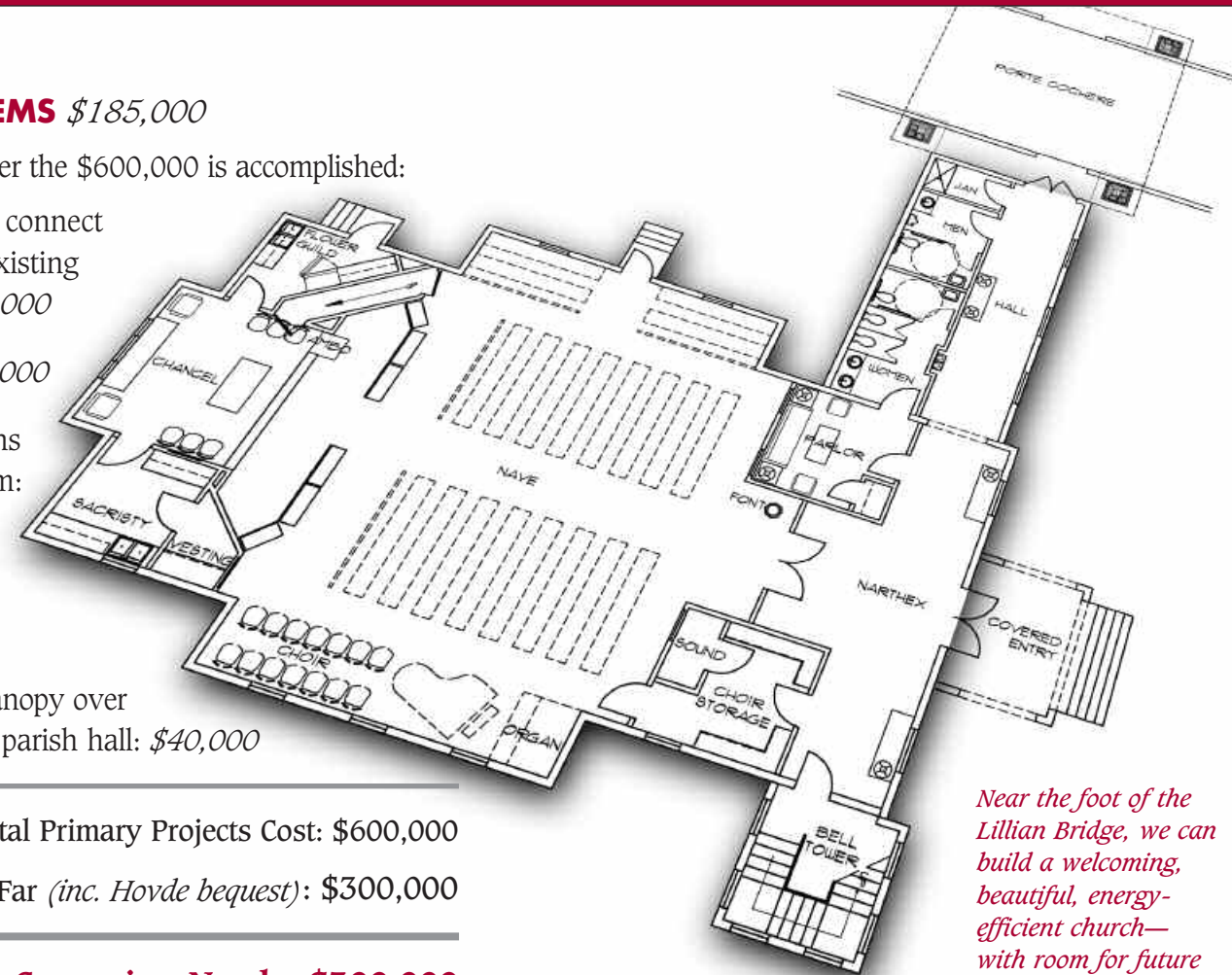

Near the foot of the Lillian Bridge, we can build a welcoming, beautiful, energy-efficient church—with room for future growth. Your generous pledge makes this Bridge to a Dream possible.

GIFTS ESSENTIAL TO RAISE \$300,000

Size of Gift	Number of Gifts	Cumulative Total	Monthly Over 3 Years
\$50,000	1	\$50,000	\$1,389
\$25,000	2	\$100,000	\$694
\$10,000	6	\$160,000	\$278
\$5,000	10	\$210,000	\$139
\$3,000	15	\$255,000	\$83
\$1,000	20	\$275,000	\$28
\$500	30	\$290,000	\$14
Less than \$500	Many	Goal Achieved	Variable

In addition to your campaign pledge, you may also wish to consider making a planned gift to Advent. For more information, contact the church office.

No matter how you decide to help: **thank you.**